

KITSOUND

CLOCK DOCK



User Manual - Before using, please read the manual carefully

Main Features

- Digital clock and alarm clock - with independent snooze and dimmer function
- Digital tune FM Radio
- White LCD display with blue back light
- Compatible with most iPods, with an integrated universal dock for charging your iPod
- Last station, volume and function memory
- Stereo speakers
- 3.5mm audio AUX input jack connected to any portable audio device
- 20 station memory presets
- iPhone incoming call alert
- Wake to iPhone/iPod, radio or buzzer

Main Controls

FRONT VIEW

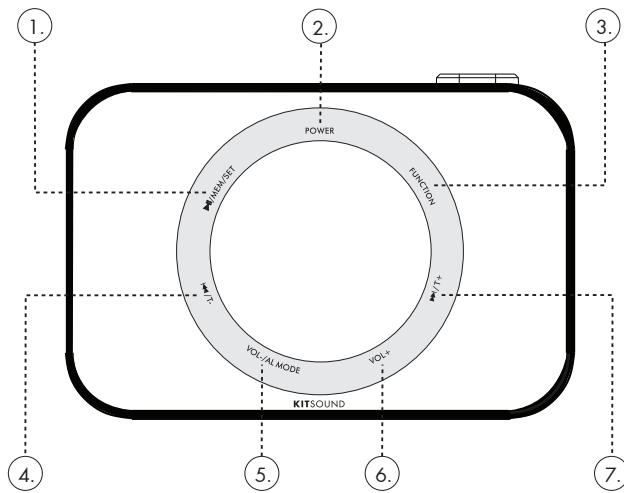

1. **▶||/MEM/SET** - Play and pause/Memory/Clock setting
2. **POWER** - Power on or off
3. **FUNCTION** - Mode alternation
4. **◀◀/T-** - Search-/Last/Backward
5. **VOL-/AL MODE** - Volume down /Alarm mode
6. **VOL+** - Volume up
7. **▶▶/T+** - Search +/ Next/Forward

SIDE VIEW

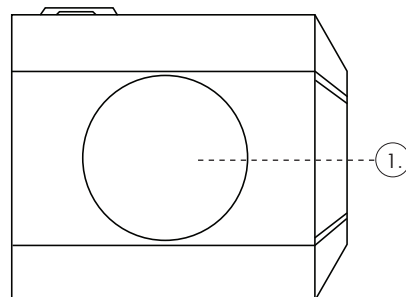

1. Built-in quality speaker

TOP VIEW

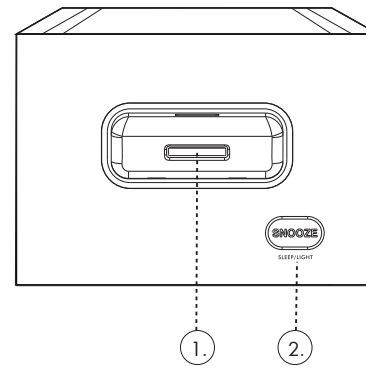

REAR VIEW

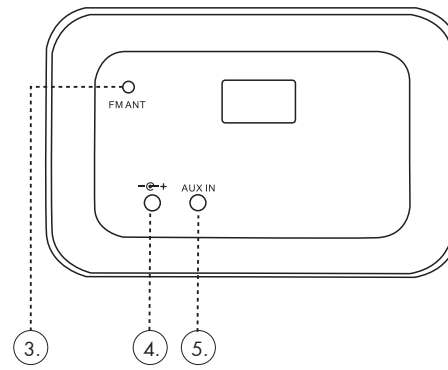

1. DOCK for iPod and iPhone
2. SNOOZE/SLEEP/LIGHT - Alarm snooze/Sleep selecting /LCD brightness adjustment
3. FM ANT -FM antenna lead
4. **⊖ ⊕** -Power input jack
5. AUX IN -3.5mm auxiliary input jack

Function operation

Power On:

Input DC 5V into the Input Source at the back of the music station, light the display and clock appears, then tap "POWER" lab.

Music Play:

1. IPHONE operation:

The music station will enter to "IPHONE" function directly when power on. Dock iPhone/iPod on the iPod dock, and play the music from iPhone/iPod. (iPod/iPhone can be charged when the main unit connects to power).

Pause:

Under "IPHONE/IPOD" mode, press "▶||" for pause. (Note: there is no "▶" or "||" on the LCD when iPhone/iPod" is played or paused, but on the iPhone/iPod itself).

Music selection:

Press "◀◀/T-" or "▶▶/T+" for music selection when iPhone/iPod is played or paused.

Backward/Forward:

Press "◀◀/T-" or "▶▶/T+" and hold it for backward or forward when iPhone/iPod is played or paused.

iPhone incoming call alert:

When there is an incoming call during iPhone music playing, the music station will stop the music and alternate it into ringtone.

2. TUNER operation

Manual Tuner or Automatic Tuner:

Press "◀◀/T-" or "▶▶/T+" for manual tuner, while press "◀◀/T-" or "▶▶/T+" and hold it for two seconds when enter to automatic tuner. The tuner will stop automatically when get access to channels.

Manual channel memory:

When get access to the channels by manual, press "▶▶/MEM/SET" and hold for a while. Press "◀◀/T-" or "▶▶/T+" to choose the saving location. 20 channles can be memorized and saved.

Memory selection:

Press "▶▶/MEM/SET" to alternate the memory channel.

3. AUX operation

Select AUX under power on and input the external music source to AUX, turn on volume and the music is ready.

Volume:

VOL- and VOL+ can be adjusted within 00-20.

Clock setting:

Under standby mode, press "▶▶/MEM/SET" and hold it into clock setting, then there will be clock shining on LCD. Tap "◀◀/T-" or "▶▶/T+" to set "hour" and tap "▶▶/MEM/SET" to set "minute", then press "▶▶/MEM/SET" again to confirm the setting and resume to clock mode.

Alarm setting:

Under STAND BY mode, press and hold "VOL-/AL MODE" when there will be time displaying and LCD shinning. Tap "◀◀/T-" or "▶▶/T+" to set "hour", and "VOL-/AL MODE" to set "minute" and then tap "VOL-/AL MODE" again to confirm the setting and return to clock mode.

Alarm mode setting:

Tap "◀◀/T-" or "▶▶/T+" and enter into the alarm setting mode (TONE/IPOD/RADIO). Select the mode and tap "VOL-/AL MODE" to return to clock mode.

SNOOZE:

When Alarm rings, press "SNOOZE" to set up snooze function. Then alarm pauses and will ring again in 9 minutes, if press "POWER" at this time, the alarm will stop and terminate.

SLEEP:

Press "SNOOZE/SLEEP/LIGHT" under any mode and then start to set the snooze and select 120M-90M-60M-30M-15M-OFF.

LIGHT:

There are three brightness modes of LCD when the unit is in stand-by.

Specifications:

Power supply	DC 5V
	AC 100 - 240 V adapter
Tuning system FM	87.5 - 108 MHz
Tuning sensitivity	FM < 20 dB
Frequency response	20 Hz - 20 kHz (aux in)
S/N Ratio	> 60 dB
Audio output	Stereo speaker (1.2 W x 2)
Audio input	iPod dock
	3.5 mm auxiliary line in

Specifications and instructions manual are subject to change without notice.