

ALCATEL *Tribe* 3040
3040G
3040D

www.alcatelonetouch.com



For more information on how to use the phone, please go to www.alcatelonetouch.com and download the complete user manual. Moreover, on the website, you can also find answers to frequently asked questions, and so much more.

ALCATEL *onetouch*.

ALCATEL *onetouch*.

Note:

This is a shared user manual for ALCATEL 3040G/3040D specifying Dual SIM information where relevant.

Introduction.....

TCT Mobile Limited would like to thank you for purchasing this mobile phone.

Home screen

- Convenient at-a-glance view of Widget applications
- Menu shortcuts for quick access
- Neat organization of applications along any edge

Power media applications

- Music player & Radio
- Video player
- Webcam

The 2.0 Megapixel camera is a good companion for PC instant message.

Bluetooth

With Bluetooth 3.0 supporting A2DP profiles, enjoy handsfree conversations.

Two SIM Card Two Standby ⁽¹⁾

With two SIM cards in one phone, users have the option to use either one or both at the same time.

⁽¹⁾ Depending on your model.

Table of contents

Safety and use.....	6
General information	11
Regulatory information	13
1 Getting started.....	15
1.1 Set-up	15
1.2 Power on your phone.....	18
1.3 Power off your phone.....	18
1.4 Using the touchscreen	18
2 Your mobile.....	19
2.1 Keys	20
2.2 Home screen.....	21
3 Making a call.....	25
3.1 Placing a call	25
3.2 Calling your voicemail	26
3.3 Receiving a call.....	26
3.4 During a call	27
3.5 Conference calls.....	27
4 Contacts.....	28
4.1 Consulting your contacts	28
4.2 Adding a contact.....	29
4.3 Contacts copying and grouping.....	30
4.4 Available options.....	31
5 Messaging.....	32
5.1 Access	32
5.2 Conversational mode	32

5.3	Write message	33
5.4	Alerts	34
5.5	Delete threads	34
5.6	Settings	34
6	Apps	36
6.1	Locate the item you want to download	36
6.2	Download, install and manage applications	37
7	Wi-Fi	38
8	Facebook	39
9	Fake call	39
10	Camera	40
10.1	Access	40
10.2	Camera	40
10.3	Video	41
11	SyncML	42
12	Image	43
13	Music	44
13.1	Music playing mode	45
14	Video	46
15	FM radio	47
16	Recorder	48
17	Settings	49
17.1	Phone settings	49
17.2	Call settings	51
17.3	Call filter	53
17.4	Network	53
17.5	Connectivity	54

17.6	Security	54
17.7	Restore default	54
17.8	Dual SIM settings	55
18	Call log	55
18.1	Access	55
18.2	Available options	55
19	Calendar	56
20	Tasks	57
21	Notes	57
22	Calculator	58
23	My files	59
23.1	Phone	59
23.2	SD Card	59
23.3	Memory status	60
24	Converter	61
25	Stopwatch	61
26	Ebook	62
27	Alarm	63
28	World clock	64
29	Wap	64
30	Bluetooth™	65
31	Services	67
32	Profiles	67
32.1	General	67
32.2	Vibrate	68
32.3	Silence	68
32.4	Flight mode	68

33	Twitter	68
34	Y! Weather	69
35	Gameloft	69
36	Making the most of your mobile.....	70
36.1	PC suite	70
36.2	Webcam	71
37	Latin input mode/character table.....	72
38	Telephone warranty	74
39	Accessories	76
40	Troubleshooting.....	77



www.sar-tick.com

This product meets applicable national SAR limits of 2.0 W/kg. The specific maximum SAR values can be found on page 9 of this user guide.

When carrying the product or using it while worn on your body, either use an approved accessory such as a holster or otherwise maintain a distance of 10 mm from the body to ensure compliance with RF exposure requirements. Note that the product may be transmitting even if you are not making a phone call.

Safety and use.....

We recommend that you read this chapter carefully before using your phone. The manufacturer disclaims any liability for damage, which may result as a consequence of improper use or use contrary to the instructions contained herein.

• TRAFFIC SAFETY:

Given that studies show that using a mobile phone while driving a vehicle constitutes a real risk, even when the hands-free kit is used (car kit, headset...), drivers are requested to refrain from using their mobile when the vehicle is not parked.

When driving, do not use your phone and headphone to listen to music or to the radio. Using a headphone can be dangerous and forbidden in some areas.

When switched on, your phone emits electromagnetic waves that can interfere with the vehicle's electronic systems such as ABS anti-lock brakes or airbags. To ensure that there is no problem:

- do not place your phone on top of the dashboard or within an airbag deployment area,
- check with your car dealer or the car manufacturer to make sure that the dashboard is adequately shielded from mobile phone RF energy.

• CONDITIONS OF USE:

You are advised to switch off the telephone from time to time to optimise its performance.

Switch the phone off before boarding an aircraft.

Switch the phone off when you are in health care facilities, except in designated areas. As with many other types of equipment now in regular use, mobile telephones can interfere with other electrical or electronic devices, or equipment using radio frequency.

Switch the phone off when you are near gas or flammable liquids. Strictly obey all signs and instructions posted in a fuel depot, petrol station, or chemical plant, or in any potentially explosive atmosphere.

When the phone is switched on, it should be kept at least 15 cm from any medical device such as a pacemaker, a hearing aid or insulin pump, etc. In particular when using the phone, you should hold it against the ear on the opposite side to the device, if any.

To avoid hearing impairment, pick up the call before holding your phone to your ear. Also move the handset away from your ear while using the "hands-free" mode because the amplified volume might cause hearing damage.

Do not let children use the phone and/or play with the telephone and accessories without supervision.

When replacing the cover please note that your phone may contain substances that could create an allergic reaction.

Always handle your phone with care and keep it in a clean and dust-free place.

Do not allow your phone to be exposed to adverse weather or environmental conditions (moisture, humidity, rain, infiltration of liquids, dust, sea air, etc). The manufacturer's recommended operating temperature range is -10°C to +55°C.

At over 55°C the legibility of the phone's display may be impaired, though this is temporary and not serious.

Emergency call numbers may not be reachable on all cellular networks. You should never rely only on your phone for emergency calls.

Do not open, dismantle or attempt to repair your mobile phone yourself.

Do not drop, throw or bend your mobile phone.

Do not paint it.

Use only batteries, battery chargers, and accessories which are recommended by TCT Mobile Limited and its affiliates and are compatible with your phone model (see Accessories List, page 77). TCT Mobile Limited and its affiliates disclaim any liability for damage caused by the use of other chargers or batteries.

Remember to make back-up copies or keep a written record of all important information stored in your phone.

Some people may suffer epileptic seizures or blackouts when exposed to flashing lights, or when playing video games. These seizures or blackouts may occur even if a person never had a previous seizure or blackout. If you have experienced seizures or blackouts, or if you have a family history of such occurrences, please consult your doctor before playing video games on your phone or enabling a flashing-lights feature on your phone.

Parents should monitor their children's use of video games or other features that incorporate flashing lights on the phones. All persons should discontinue use and consult a doctor if any of the following symptoms occur: convulsion, eye or muscle twitching, loss of awareness, involuntary movements, or disorientation. To limit the likelihood of such symptoms, please take the following safety precautions:

- Do not play or use a flashing-lights feature if you are tired or need sleep.
- Take a minimum of a 15-minute break hourly.
- Play in a room in which all lights are on.
- Play at the farthest distance possible from the screen.
- If your hands, wrists, or arms become tired or sore while playing, stop and rest for several hours before playing again.
- If you continue to have sore hands, wrists, or arms during or after playing, stop the game and see a doctor.

When you play games on your phone, you may experience occasional discomfort in your hands, arms, shoulders, neck, or other parts of your body. Follow the instructions to avoid problems such as tendinitis, carpal tunnel syndrome, or other musculoskeletal disorders.



PROTECT YOUR HEARING

To prevent possible hearing damage, do not listen at high volume levels for long periods. Exercise caution when holding your device near your ear while the loudspeaker is in use.

• PRIVACY:

Please note that you must respect the laws and regulations in force in your jurisdiction or other jurisdiction(s) where you will use your mobile phone regarding taking photographs and recording sounds with your mobile telephone. Pursuant to such laws and regulations, it may be strictly forbidden to take photographs and/or to record the voices of other people or any of their personal attributes, and duplicate or distribute them, as this may be considered to be an invasion of privacy. It is the user's sole responsibility to ensure that prior authorisation be obtained, if necessary, in order to record private or confidential conversations or take a photograph of another person; the manufacturer, the seller or vendor of your mobile phone (including the operator) disclaim any liability which may result from the improper use of the mobile phone.

• BATTERY:

Before removing the battery from your phone, please make sure that the phone is switched off.

Observe the following precautions for battery use:

- Do not attempt to open the battery (due to the risk of toxic fumes and burns).
- Do not puncture, disassemble or cause a short-circuit in a battery.
- Do not burn or dispose of a used battery in household rubbish or store it at temperatures above 60°C.

Batteries must be disposed of in accordance with locally applicable environmental regulations. Only use the battery for the purpose for which it was designed. Never use damaged batteries or those not recommended by TCT Mobile Limited and/or its affiliates.



This symbol on your telephone, the battery and the accessories means that these phones must be taken to collection points at the end of their life:

- Municipal waste disposal centres with specific bins for these items of equipment
- Collection bins at points of sale.

They will then be recycled, preventing substances being disposed of in the environment, so that their components can be reused.

In European Union countries:

These collection points are accessible free of charge.

All phones with this sign must be brought to these collection points.

In non European Union jurisdictions:

Items of equipment with this symbol are not to be thrown into ordinary bins if your jurisdiction or your region has suitable recycling and collection facilities; instead they are to be taken to collection points for them to be recycled.

CAUTION: RISK OF EXPLOSION IF BATTERY IS REPLACED BY AN INCORRECT TYPE. DISPOSE OF USED BATTERIES ACCORDING TO THE INSTRUCTIONS.

• CHARGERS

Mains powered chargers will operate within the temperature range of: 0°C to 40°C.

The chargers designed for your mobile phone meet with the standard for safety of information technology equipment and office equipment use. They are also compliant to the ecodesign directive 2009/125/EC. Due to different applicable electrical specifications, a charger you purchased in one jurisdiction may not work in another jurisdiction. They should be used for this purpose only.

• RADIO WAVES:

Proof of compliance with international standards (ICNIRP) or with European Directive 1999/5/EC (R&TTE) is required of all mobile phone models before they can be put on the market. The protection of the health and safety for the user and any other person is an essential requirement of these standards or this directive.

THIS DEVICE MEETS INTERNATIONAL GUIDELINES FOR EXPOSURE TO RADIO WAVES.

Your mobile device is a radio transmitter and receiver. It is designed not to exceed the limits for exposure to radio waves (radio frequency electromagnetic fields) recommended by international guidelines. The guidelines were developed by an independent scientific organization (ICNIRP) and include a substantial safety margin designed to assure the safety of all persons, regardless of age and health.

The radio wave exposure guidelines use a unit of measurement known as the Specific Absorption Rate, or SAR. The SAR limit for mobile devices is 2 W/kg.

Tests for SAR are conducted using standard operating positions with the device transmitting at its highest certified power level in all tested frequency bands. The highest SAR values under the ICNIRP guidelines for this device model are:

3040G:

Maximum SAR for this model and conditions under which it was recorded.		
Head SAR	GSM 900 + Wi-Fi + Bluetooth	0.725 W/kg
Body-worn SAR	GSM 900 + Wi-Fi + Bluetooth	0.860 W/kg

3040D:

Maximum SAR for this model and conditions under which it was recorded.		
Head SAR	GSM 900 + Wi-Fi + Bluetooth	0.725 W/kg
Body-worn SAR	GSM 900 + Wi-Fi + Bluetooth	0.860 W/kg

During use, the actual SAR values for this device are usually well below the values stated above. This is because, for purposes of system efficiency and to minimize interference on the network, the operating power of your mobile device is automatically decreased when full power is not needed for the call. The lower the power output of the device, the lower its SAR value.

Body-worn SAR testing has been carried out at a separation distance of 10 mm. To meet RF exposure guidelines during body-worn operation, the device should be positioned at least this distance away from the body. If you are not using an approved accessory ensure that whatever product is used is free of any metal and that it positions the phone the indicated distance away from the body.

Organizations such as the World Health Organization and the US Food and Drug Administration have stated that if people are concerned and want to reduce their exposure they could use a hands-free device to keep the phone away from the head and body during phone calls, or reduce the amount of time spent on the phone.

For more information you can go to www.alcatelonetouch.com

Additional information about electromagnetic fields and public health are available on the following site: <http://www.who.int/peh-emf>.

Your telephone is equipped with a built-in antenna. For optimal operation, you should avoid touching it or degrading it.

As mobile devices offer a range of functions, they can be used in positions other than against your ear. In such circumstances the device will be compliant with the guidelines when used with headset or usb data cable. If you are using another accessory ensure that whatever product is used is free of any metal and that it positions the phone at least 10 mm away from the body.

• LICENCES

Obigo®

is a registered trademark of Obigo AB.



microSD Logo is a trademark.



The Bluetooth word mark and logos are owned by the Bluetooth SIG, Inc. and any use of such marks by TCT Mobile Limited and its affiliates is under license. Other trademarks and trade names are those of their respective owners.

ALCATEL 3040G/3040D Bluetooth QD ID B020475



zi corporation

eZiText™ and Zi™ are trademarks of Zi Corporation and/or its Affiliates.



Facebook and the f Logo are trademarks of Facebook, Inc., and are used under license.



Twitter and the T Logo are trademarks of Twitter, Inc., and are used under license.



The Wi-Fi Logo is a certification mark of the Wi-Fi Alliance.

Your device uses non-harmonised frequency and is intended for use in all European countries. The WLAN can be operated in the EU without restriction indoors, but cannot be operated outdoors in France.

General information

- **Internet address:** www.alcatelonetouch.com
- **Hot Line Number:** see "TCT Mobile Services" leaflet or go to our Internet site.
- **Address:** Room 1910-12A, Tower 3, China HK City, 33 Canton Road, Tsimshatsui, Kowloon, Hong Kong

On our Internet site, you will find our FAQ (Frequently Asked Questions) section. You can also contact us by e-mail to ask any questions you may have.

An electronic version of this user guide is available in English and other languages according to availability on our server:

www.alcatelonetouch.com

Your telephone is a transceiver that operates on GSM in quad-band with 850/900/1800/1900 MHz.

CEI588

This equipment is in compliance with the essential requirements and other relevant provisions of Directive 1999/5/EC. The entire copy of the Declaration of Conformity for your telephone can be obtained through our website: www.alcatelonetouch.com.

Protection against theft ⁽¹⁾

Your telephone is identified by an IMEI (phone serial number) shown on the packaging label and in the phone's memory. We recommend that you note the number the first time you use your telephone by entering * # 0 6 # and keep it in a safe place. It may be requested by the police or your operator if your telephone is stolen. This number allows your mobile telephone to be blocked preventing a third person from using it, even with a different SIM card.

Disclaimer

There may be certain differences between the user manual description and the phone's operation, depending on the software release of your telephone or specific operator services.

TCT Mobile shall not be held legally responsible for such differences, if any, nor for their potential consequences, which responsibility shall be borne by the operator exclusively.

⁽¹⁾ Contact your network operator to check service availability.

Regulatory information

The following approvals and notices apply in specific regions as noted.

3040G:

TCT Mobile

TCT Mobile Europe SAS
55 Avenue des Champs Piereux,
Immeuble Le Capitole 92000 Nanterre, France
+33 1 46 82 61 00

EC declaration of conformity / Déclaration de conformité CE

Product / Produit : GSM quad bands handheld station with bluetooth technology, WIFI and FM radio / GSM quadribandes avec technologie Bluetooth, Wifi et radio FM

Product Identification / Identification du produit :
We / Nous TCT Mobile Europe SAS
55, avenue des Champs Piereux
92000 Nanterre
France

Declare under our sole responsibility that the product above mentioned is conform to the applicable essential requirements of the directive 1999/5/EC and that all essential radio test suites have been carried out. Conformity assessment procedure : annexe IV of the directive. / Je déclare sous notre entière responsabilité que le produit ci-dessus est en conformité avec les exigences essentielles applicables de la directive 1999/5/CE et que toutes les séries d'essais radio essentielles ont été effectuées. Procédure d'évaluation de conformité : annexe IV de la directive.

- Applied standards / Normes appliquées :
- Item 3.1.a (protection of the health and of the safety of the user) / Article 3.1.a (protection de la santé et de la sécurité de l'utilisateur)
 - EN 60950-1:2006 + A11:2009 + A12:2011 + A1:2010
 - EN 62209-1 (2009)
 - EN 62209-2 (2010)
 - EN 50 300: 2001/AC:2006, Council recommendation 1999/5/19/EC (July 99)
 - Item 3.1.b (protection requirements with respect to electromagnetic compatibility) / Article 3.1.b (exigences de protection en ce qui concerne la compatibilité électromagnétique)
 - EN 301 489-1 v.1.9.2 (2011-09), EN 301 489-7 v.1.3.1 (2005-11), EN 301 489-17 v.2.1.1 (2009-05)
 - Item 3.2 (effective use of spectrum so as to avoid harmful interferences) / Article 3.2 (utilisation efficace du spectre radioélectrique de façon à éviter les interférences dommageables)
 - EN 301 511 v.9.0.2 (2003-03), EN 300 328 v.1.7.1 (2006-10)

This product also conforms to the applicable requirements of following directives, / Ce produit est en conformité avec la directive,

- directive 2004/108/EC (electromagnetic compatibility) / Ce produit est en conformité avec la directive 2004/108/CE (compatibilité électromagnétique)
 - EN 55013:2001 +A2:2006
 - EN 55020:2007
- directive 2011/65/EU (RoHS - restriction of the use of certain hazardous substances)

This product can connect with a Common Mobile Phone Charger which complies with below standards: (Ce produit peut être utilisé avec un chargeur universel pour téléphone portable conforme aux standards suivants.)

- EN301 489-34 v1.3.1 (2012-05)
- EN301 489-34 v1.1.1 (2010-10)
- EN 62584:2010

Conformity of this product has been reviewed by the following Notified body of directive 1999/5/EC / La conformité de ce produit a été vérifiée par l'organisme de certification (notified body) suivant.

American Certification Body, Inc.
Suite C110, Whittier Avenue 6731, 22101 McLean, Virginia, United States
Identification number: 1588

Date :2013-03-25

Signature

TCT Mobile Europe SAS / Deputy General Manager, EMEA

CE1588

3040D:

TCT Mobile

TCT Mobile Europe SAS
55 Avenue des Champs Piereux,
Immeuble Le Capitole 92000 Nanterre, France
+33 1 46 82 61 00

EC declaration of conformity / Déclaration de conformité CE

Product / Produit : GSM quad bands handheld station with bluetooth technology, WIFI and FM radio / GSM quadribandes avec technologie Bluetooth, Wifi et radio FM

Product Identification / Identification du produit :
We / Nous TCT Mobile Europe SAS
55, avenue des Champs Piereux
92000 Nanterre
France

Declare under our sole responsibility that the product above mentioned is conform to the applicable essential requirements of the directive 1999/5/EC and that all essential radio test suites have been carried out. Conformity assessment procedure : annexe IV of the directive. / Je déclare sous notre entière responsabilité que le produit ci-dessus est en conformité avec les exigences essentielles applicables de la directive 1999/5/CE et que toutes les séries d'essais radio essentielles ont été effectuées. Procédure d'évaluation de conformité : annexe IV de la directive.

- Applied standards / Normes appliquées :
- Item 3.1.a (protection of the health and of the safety of the user) / Article 3.1.a (protection de la santé et de la sécurité de l'utilisateur)
 - EN 60950-1:2006 + A11:2009 + A12:2011 + A1:2010
 - EN 62209-1 (2009)
 - EN 62209-2 (2010)
 - EN 50 300: 2001/AC:2006, Council recommendation 1999/5/19/EC (July 99)
 - Item 3.1.b (protection requirements with respect to electromagnetic compatibility) / Article 3.1.b (exigences de protection en ce qui concerne la compatibilité électromagnétique)
 - EN 301 489-1 v.1.9.2 (2011-09), EN 301 489-7 v.1.3.1 (2005-11), EN 301 489-17 v.2.1.1 (2009-05)
 - Item 3.2 (effective use of spectrum so as to avoid harmful interferences) / Article 3.2 (utilisation efficace du spectre radioélectrique de façon à éviter les interférences dommageables)
 - EN 301 511 v.9.0.2 (2003-03), EN 300 328 v.1.7.1 (2006-10)

This product also conforms to the applicable requirements of following directives, / Ce produit est en conformité avec la directive,

- directive 2004/108/EC (electromagnetic compatibility) / Ce produit est en conformité avec la directive 2004/108/CE (compatibilité électromagnétique)
 - EN 55013:2001 +A2:2006
 - EN 55020:2007
- directive 2011/65/EU (RoHS - restriction of the use of certain hazardous substances)

This product can connect with a Common Mobile Phone Charger which complies with below standards: (Ce produit peut être utilisé avec un chargeur universel pour téléphone portable conforme aux standards suivants.)

- EN301 489-34 v1.3.1 (2012-05)
- EN301 489-34 v1.1.1 (2010-10)
- EN 62584:2010

Conformity of this product has been reviewed by the following Notified body of directive 1999/5/EC / La conformité de ce produit a été vérifiée par l'organisme de certification (notified body) suivant.

American Certification Body, Inc.
Suite C110, Whittier Avenue 6731, 22101 McLean, Virginia, United States
Identification number: 1588

Date :2013-03-29

Signature

TCT Mobile Europe SAS / Deputy General Manager, EMEA

CE1588

Getting started

1.1 Set-up

Removing or installing the back cover

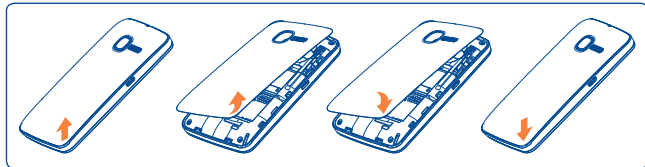

Removing and installing the battery

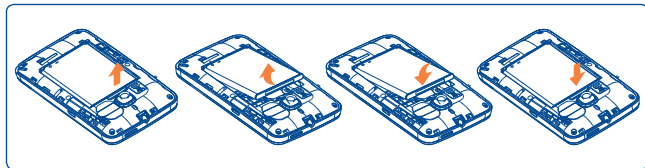

- Insert and click the battery into place, then close the telephone cover.
- Unclip the cover, then remove the battery.

Inserting and removing the SIM card ⁽¹⁾

You must insert your SIM card to make phone calls. Please power off your phone and remove battery before inserting or removing the SIM card.

3040G

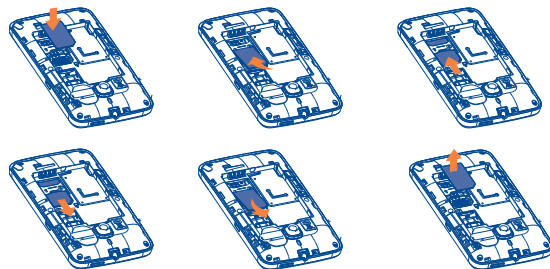

3040D

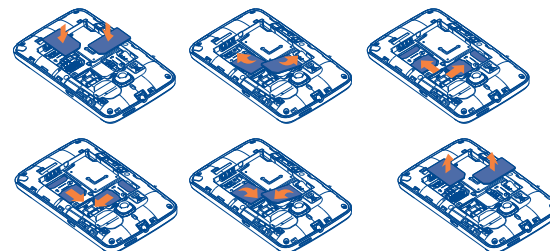

Place the SIM card with the chip facing downwards and slide it into its housing. Make sure that it is correctly inserted. To remove the card, press it and slide it out.

3040D, two SIM cards can be inserted.

⁽¹⁾ Check with your network operator to make sure that your SIM card is 3V or 1.8V compatible. The old 5 Volt cards can no longer be used. Please contact your operator.

Charging the battery

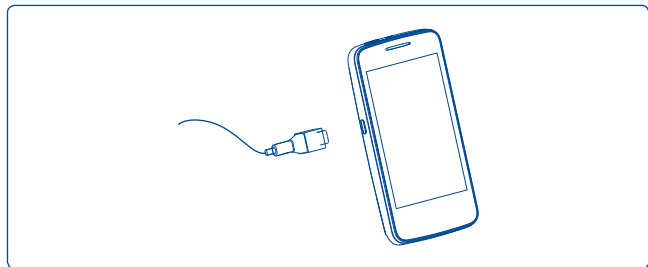

Connect the battery charger to your phone and mains socket respectively.

- The charging may take about 20 minutes to start if the battery is flat.
- Be careful not to force the plug into the socket.
- Make sure the battery is correctly inserted before connecting the charger.
- The mains socket must be near to the phone and easily accessible (avoid electric extension cables).
- When using your telephone for the first time, charge the battery fully (approximately 3 hours). You are advised to fully charge the battery (🔋).
- To reduce power consumption and energy waste, when battery is fully charged, disconnect your charger from the plug; switch off Bluetooth when not in use, etc.



The charge is complete when the animation stops.

1.2 Power on your phone

Hold down the  key until the telephone powers on, type in your PIN code if necessary and then confirm. The Home screen is displayed.

If you do not know your PIN code or if you have forgotten it, contact your network operator. Do not leave your PIN code with your telephone. Store this information in a safe place when not in use.

If Broadcast SMS are displayed, touch to browse through them or press  to return to the Home screen.

While the phone is searching for a network, "Searching/Emergency" will be displayed.

1.3 Power off your phone

Hold down the  key until the telephone powers off.

1.4 Using the touchscreen

Touch



To access an application, touch it with your finger.

Drag



Place your finger on the screen to drag the object to the destination.

Scroll



Slide the screen to scroll up and down the applications, images, web pages...at your convenience.

2 Your mobile

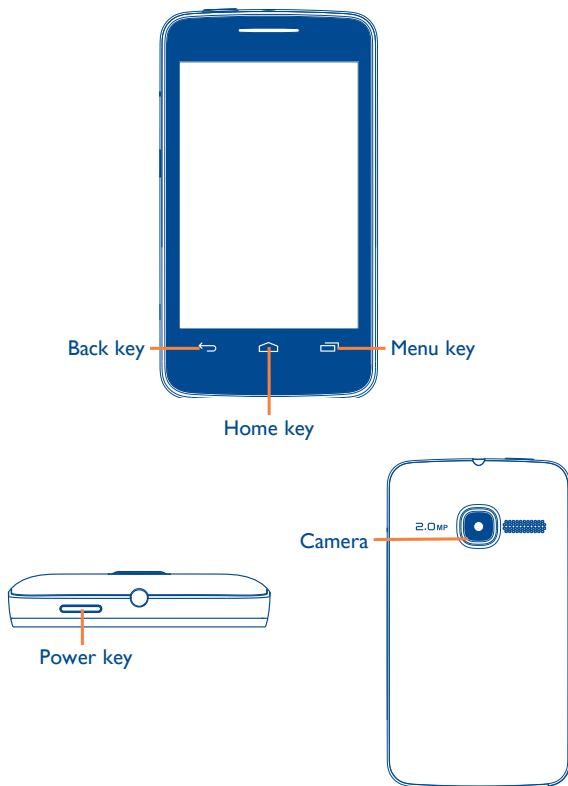

2.1 Keys



Menu key
- Options menu



Home key
- Return to the Home screen



Back key
- Return to previous menu



Power key
- Lock the screen (press)
- Turn your screen on/off (press)
- Power on/off (press and hold)
- Mute an incoming call

2.2 Home screen

You can bring all the items (shortcuts and widgets) you love or use most frequently to your Home screen for quick access.



The Home screen is provided in an extended format to provide you with more space for adding widgets and shortcuts. Slide the Home screen horizontally leftwards or rightwards to get a complete view of the Home screen. Small dots at the bottom of the screen indicate which screen you are viewing.

2.2.1 Main screen icons ⁽¹⁾

In 3040G:



Battery charge level



Vibrate alert: your phone vibrates, but does not ring or beep (see page 67).



Bluetooth status (Activated).



Headset connected.



Screen locked.



Call forwarding activated: your calls are forwarded (see page 51).



Alarm or appointments programmed (see page 56, 63).



Level of network reception.



Voicemail message arrived.















Missed calls.







Radio is on.

⁽¹⁾ The icons and illustrations in this guide are provided for information purposes only.

-  **Wap alerts** ⁽¹⁾.
-  **Roaming.**
-  **SIM card missing.**
-  **GPRS connection status** (Activated).
-  **GPRS connecting.**
-  **Sending a MMS.**
-  **MMS receiving.**
-  **Silence mode:** your phone does not ring, beep or vibrate with the exception of the alarm (see page 68).
-  **SMS unread.**
-  **MMS unread.**
-  **Flight mode.**
-  **microSD card inserted.**

In 3040D:

-  **Call forwarding activated:** your calls are forwarded.
-  **Level of network reception.**
-  **GPRS connection status** (Activated).
-  **GPRS connecting.**

2.2.2 Status list

The Status list contains information about significant events, like Missed calls, Unread messages, etc. The purpose is to allow you faster access to the interactive applications.

Touch the status bar and drag down to open, drag up to close.

To open an application, touch it from the list.

2.2.3 Toolbar

Toolbar with 4 fixed shortcuts to access **Making a call**, **Contacts**, **Messaging**, **Main menu**.

2.2.4 Personalize the Homescreen

Adding items

To add an item from the main menu, you can select one of the following ways:



- Touch and hold an item from the main menu list.
- Touch and hold an empty area from the Home screen, then touch the item you want to add to the Home screen.

Removing items

Touch and hold the application on the Home screen or an empty area, touch the application to remove.

Customizing wallpaper

To personalize your wallpaper, you can select one of the following two ways:



- Touch and hold an empty area from the Home screen, touch , then touch a folder to select an image as your wallpaper.
- Touch , select **"Wallpaper"**, then touch a folder to select an image as your wallpaper (See page 43).

⁽¹⁾ Depending on your network operator.



3 Making a call.....

3.1 Placing a call

Touch  on the tool bar to place a call.

Enter the desired number on the on-screen keypad directly or select a contact from Call log or Contacts by touching  or  respectively, then touch  to place the call.

For dual SIM model, you can select either of them to place a call.

The number you entered can be saved to Contacts by selecting . If you make a mistake, you can delete the incorrect digits by touching .

To hang up the call, press the  key.

Making an emergency call

If your phone has network coverage, dial emergency number and touch  to make an emergency call. This works even without a SIM card and without typing the PIN code.

3.2 Calling your voicemail ⁽¹⁾

Your voicemail is provided by your network to avoid missing calls. It works like an answering machine that you can consult at any time. To access your voicemail, hold down  on the on-screen keypad.

If the access number for your operator's voicemail service does not work, dial the number that you were given. To change this number at a later date, refer to "**My numbers**" (see page 55).



To use your voicemail service from abroad, contact your network operator before leaving.

3.3 Receiving a call

When you receive an incoming call, drag the green phone icon  down to answer.

If the  icon is displayed, the vibrator is activated and there is no ringtone.

If the  icon is displayed, the phone neither rings nor vibrates.





The caller's number is displayed if it is transmitted by the network (contact your network operator to check service availability).

Muting the ringtone

You may mute ringtone of current incoming call by press .

Rejecting a call

Press the  key to mute a call or drag the red phone icon  up to reject the call.

⁽¹⁾ Contact your network operator to check service availability.

3.4 During a call ⁽¹⁾

Available functions

During a call, touch **"More"** to use your contacts, calendar, short messages etc. without losing your caller.



Move the handset away from your ear while turn on the speaker because the amplified volume might cause hearing damage.

Adjusting the volume

You can adjust the sound level during a call.

Handling two calls

- Answering a second call (ensure that **"Call waiting"** is activated, see page 51).
- To call a second party during a call, you may touch **"Call"**.

3.5 Conference calls ⁽¹⁾

Your phone allows you to talk to several people at the same time (up to five). If you are on a double call, touch **"More"** and select **"Conference call"**. If a third call comes in, answer it by dragging the green phone icon  down and speak with your new caller.

This caller becomes a member of the conference if you press **"More"** and select **"Conference call"**.

⁽¹⁾ Contact your network operator to check service availability.

4 Contacts

4.1 Consulting your contacts

To access the Contacts, touch  from tool bar or touch  from tool bar to enter the main menu, and select **"Contacts"**.

The whole contact list is categorized by Contacts  and group .

For dual SIM model, you can view contacts information from SIM1, SIM2 and Phone.







For the first time consulting you contacts, your are asked whether to import contact from SIM card to your phone. For dual SIM model, you can select to import contact from either or both SIM1/ SIM2.

Searching for a contact

Touch  to search for a contact by inputting the initial of his/her name. Subsequent letters may be added to refine the search. Alternatively scroll up/down to find the contact you need after reaching the initial letter within the contact list (A-Z) section.

Viewing a contact

Select a name from your contacts to read the contact information, and you can have the following options by touching the icons:

-  Delete
-  Send the contact a message
-  Edit details about the contact
-  Send vCard by SMS, MMS or Bluetooth
-  Set a number to Copy contacts to SIM, Add to blacklist or Add to whitelist

4.2 Adding a contact

You can add a new contact by touching , and choose to save it to SIM or to phone.

Following fields are accessible when you create a new contact in the Contacts by touching : **Name**, **Number**, **Work**, **Home**, **Email**, **Birthday**, **Ringtone**, **Group** and **Address**.

For dual SIM model, you can add a contact and select to Copy to SIM1/SIM2.

Birthday reminder

You can set a birthday reminder when editing contact information.



-  If you use your phone abroad, store the numbers in your Contacts in international format "+" followed by the country code.

4.3 Contacts copying and grouping

In **Contacts**, you can copy the selected contact from/to a SIM card.

When viewing a phone contact's information, select "**Copy contact to SIM**" by touching .

When viewing a SIM contact, select "**Copy contact to phone**" by touching .

To group contacts, you need to create a group first. Go to the All contacts or Phone contacts tab, tap  to enter **Group** and then  to create a group.

After you have created a group, go to **Group** and touch , then mark the checkbox before contacts, touch **Done**.

For dual SIM Model, you can make full use of both SIM1 and SIM2 for information backup.

4.4 Available options

From the contact list, you can access the following options:

Send message	Send an SMS/MMS to a contact you selected from the Contacts.
Delete	Delete the selected contact.
ICE contact	Set 3 numbers as emergency call.
Copy contact to phone	Copy the contact you selected from SIM card to phone if there is sufficient memory.
Copy contact to SIM	Copy the contact you selected from phone to SIM card if there is sufficient memory.
My number	Type in, modify or send the user's own number by SMS/MMS/Bluetooth.
Preferred storage	Select the preferred storage location for messages.
Memory status	View used and available space in SIM and Phone memory for contacts.
Add to blacklist	Add to the selected contact to blacklist.

5 Messaging

You can create, edit and receive SMS and MMS with this mobile phone.



MMS enables you to send video clips, images, photos, animations and sounds to other compatible mobiles.



The MMS function can only be used if the service is provided by your operator, and if your contract includes the MMS option and if all the parameters for MMS have been entered (see page 35).

5.1 Access





You may access this menu using the following options:

- Touch  to enter the main menu screen, and then select .
- Access from tool bar by selecting .

5.2 Conversational mode



In conversational view mode, you can view chat history in chronological order.

Useful icons:

-  Write msg
-  Delete
-  Mark
-  Settings

5.3 Write message

Touch  to create text/multimedia messages.

One or more recipients can be added from the contact list. To remove a recipient, move the cursor to the end of the recipient's name, and touch . You can select a recipient from Contacts by touching .

For dual SIM model, you can select recipients in either SIM1 or SIM2 contacts and select the number you wish to send.

An SMS will be converted to MMS automatically when: images, videos, audio, slides or attachments are inserted; Subject, CC/BCC/email address is added; or the message contains more than 8 pages of text.



Specific letters (accent) will increase the size of the SMS, this may cause multiple SMS to be sent to your recipient.

Timer send

Schedule an SMS/MMS to be sent out at predefined time (select "**Timer send**" via .



An SMS message of more than a certain number of characters (the number of characters depends on your language) will be charged as several SMS. An MMS message containing photos and/or sounds may also be billed as more than one message.

5.4 Alerts

5.4.1 Voicemail server

View and edit your voicemail number.

5.4.2 Broadcast SMS

Folder for broadcast SMS.

5.5 Delete threads

To delete threads (containing all conversations), touch .

5.6 Settings

By touching , setting options for **Text message**, **MMS**, **Push msg. set**, **Broadcast SMS** are available.

Text messages

Memory status	Memory used on the phone.
Save sent message	Touch On/Off to save sent message.
Prefer storage	Select default message storage, SIM or phone.
Alphabet management	Enables the definition of SMS data coding for SMS sending.

Multimedia messages

Edit	Set slide timing, edit mode, Picture resize, signature, etc.
Sending	Set the values for validity period, Read report, etc.
Retrieve	Set the values for Home network, Roaming network, etc.
Preferred storage	Set preferred storage as phone or memory card.
Memory status	Memory used and free on the phone.
<u>Push msg. set</u>	
Enable push	Enable to set push message with selecting Accept all or Disabled.
Enable service loading	Select Prompt, Auto launch or Disabled to set loading service.

Broadcast SMS ⁽¹⁾

Receive mode	Enable to receive Broadcast SMS.
Languages	Language selection.
Channel setting	Select/Add/Edit/Delete channels.
Ringtone setting	Enable to select ringtone.

⁽¹⁾ Depending on your network operator.

6 Apps ⁽¹⁾



Apps is an online software store, where you can download and install applications and games to your phone. All downloaded files can be found in "**Apps Mgr**" that can be accessed from main menu.

6.1 Locate the item you want to download

The Apps store home page offers several ways to find applications. It showcases different kinds of applications in **Featured** and **Categories**.

Featured: This shows pictures of recommended applications. You can select one to view its details.

Categories: This arranges applications under **Game, Tool, Wallpaper, Music**. Select a category to choose the application you require.

Also, you can press the Search tab, enter the name of an application, and then press **Go** to find the result.

⁽¹⁾ Depending on your network operator.

6.2 Download, install and manage applications

- Navigate to the item you want to download and select it to enter the details screen from which you can read its overall rating or comments, view developer's information, etc.
- To download an application, you can press **Download** from the application details screen.
- You can check the status of any application that is currently being downloaded using the Download tab. This enables you to delete, pause or resume downloading.
- When downloading has finished, you can manage your application using the Manager tab. You can select an application, and then press **Menu\Run** to install it or **Menu\Delete** to delete it.



Be particularly cautious with applications that can access many functions or a significant amount of your data. You are responsible for the results of using this item on your phone.

7 Wi-Fi



Using Wi-Fi, you can connect to the Internet when your phone is within range of a wireless network. Wi-Fi can be used on phone even when no SIM card is inserted.

To access this function, you can have the following options:

- Tap to enter the main menu and select ;
- Press directly Wi-Fi in notification bar;
- Slide the Home screen horizontally leftwards and touch in widgets bar.

To add a Wi-Fi network

Every time you turn on Wi-Fi, available Wi-Fi networks around will be searched automatically, but you may add new ones according to your preference as well.

- Touch on the tool bar.
- Enter the name of the network (SSID: Service Set Identifier) and any required network information.

You also can edit, delete and change the priority of the selected network.

To connect and disconnect to a wireless network

To connect a Wi-Fi network, touch and select **Connect**. If the network you selected is secured, you will be required to enter a password or other credentials (contact network operator for details).

To disconnect a Wi-Fi network, touch and select **Disconnect**.

8 Facebook

Facebook is a social utility that connects people with friends and others who work, study and live around them. It provides a number of features with which users may interact: Wall, a space on every user's profile page that allows friends to post messages for the user to see; Pokes, which allow users to send a virtual "poke" to each other; Gifts, a feature allowing users to send virtual gifts which appear on the recipient's profile; Market places, which lets users post free classified goods, etc.

To open an account online, please go to: <http://m.facebook.com>.

9 Fake call.....

This program enables you to call yourself by simulating a caller number/name, ringtone, at a scheduled time. It helps you to politely escape from social situations at any time you wish.

Fake call mode Enable or disable a fake call.

Set caller name/active time

Predefine settings of a caller's name and active time.

Mode You may select the mode of Ring, Vibration, Ring+Vibrate and Silence.

Ringtone You can select a melody as ringtone.

10 Camera.....

Your mobile phone is fitted with a camera for taking photos and shooting videos that you can use in different ways:



- store them in your **"My files\My images"**.
- send them directly by MMS or Bluetooth.
- personalize your main screen (see page 49).
- select them as incoming call image to a contact in your directory.

10.1 Access

To access the function from the Home screen, touch  from tool bar to access the main menu and select the  icon.

10.2 Camera

10.2.1 Take a photo, save or delete

The screen acts as the viewfinder. Position the object or landscape in the viewfinder and touch  to take the image and the images will be automatically saved. If you don't want it, you may directly delete it by touching .

10.2.2 Settings in framing mode

Before taking the photo, you can adjust a number of settings by touching .

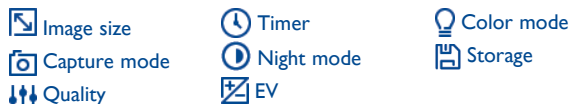

Touch  to access **My images** to view the photos you have taken.

Touch  to switch between camera mode and video mode.

10.2.3 Options available after taking the photo

Once you have taken a photo, a number of icons appear on the photo so you can choose to set it as contact image, set as wallpaper, view it in **My images**, or send by MMS, Bluetooth and more.

10.3 Video

You can record a video clip of unlimited length, as long as the battery sustains and there is sufficient memory.



10.3.1 Framing mode

When you enter the "Video" function, you are in framing mode. Use the mobile screen as a viewfinder and touch  for the **EV**, **Capture mode**, **Night mode**, **Quality**, **Record audio**, **Color mode**, and **Storage** settings.

Touch  to access **My Videos** to view the videos you have taken.

Touch  to switch between camera mode and video mode.

10.3.2 Recording mode

Once you have chosen your settings, you can launch the recording of your video-clip by touching  on the screen. Save the video by touching .

 If a call comes in while you are recording, the recording process will be automatically stopped and you will be prompted after the call if you want to save the recorded clip.

10.3.3 Further operations after shooting a video

After shooting a video, four icons will appear on the screen so you can choose to send your video by MMS/Bluetooth or access "**My videos**".

In the list of "**My videos**", touch  to the video, set as power on/off screen, Rename, etc.







SyncML could launch synchronization with the account you've set.

12 Image.....

A library links to the images in "**My images**" in phone to be shown in list, slide, set as Wallpaper, Power on/off display, and contact image or sent by MMS, Bluetooth.

Useful icons:

- | | |
|---|--|
|  | Delete |
|  | Turn the picture to right/left |
|  | Play pictures in full mode |
|  | Set as Wallpaper, Power on/off image and Contact image or send by MMS,Bluetooth. |

Touch a image once to view it in full screen:

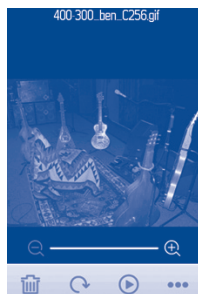

13 Music.....

Access this feature from the main menu by selecting "**Music**".

You will have full flexibility of managing music both on your mobile and SD card.

You can have access to your music files through one of the following:

- | | |
|---------------------|--|
| Play | Play the song |
| Details | Display details of the song |
| Update songs | Update the information of songs saved in phone or SD Card. |
| Delete | Delete the song |
| Delete all | Delete all songs |
| Settings | You can set Player settings when playing music. |

13.1 Music playing mode

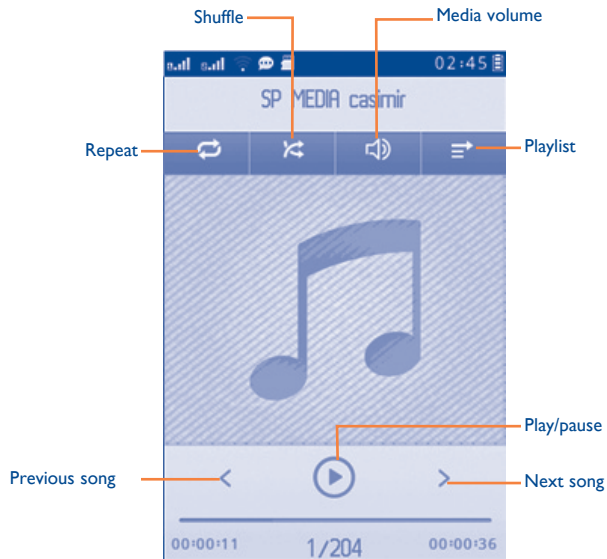

14 Video.....▶

"My videos" album contains video clips recorded, received or downloaded. All supported video clips in this folder can be played, set as power on/off display, sent, deleted, renamed.

Useful icons:



15 FM radio



Your phone is equipped with a radio ⁽¹⁾ with RDS ⁽²⁾ functionality. You can use the application as a traditional radio with saved channels or with parallel visual information related to the radio program on the display if you tune to stations that offer Visual Radio service. You can listen to it while running other applications.



To use it, you must plug in your headset, which works as an antenna connected with your phone.

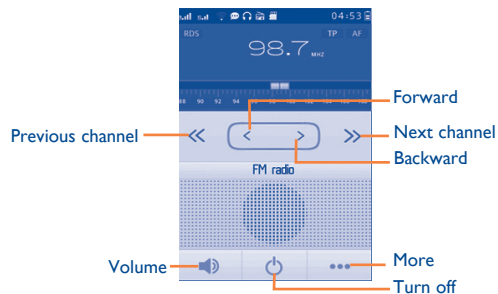

⁽¹⁾ The quality of the radio depends on the coverage of the radio station in that particular area.

⁽²⁾ Depending on your network operator and market.

Available options:

Channel list Open the list of saved stations.

Enter the frequency Enter the frequency manually.

Save channel Save the current tuned station to the "**Channel list**".

Record Record the radio: files will be automatically saved to "**My files\Sounds\Recorded**".

Settings Scroll up and down to manage settings.

16 Recorder.....



Accessing "**Recorder**" from the main menu allows you to make voice or sound recordings.

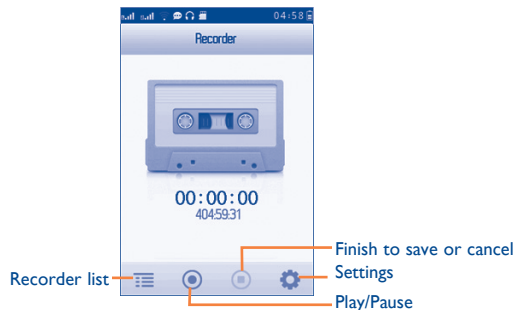

17 Settings.....

From the main menu, select the menu icon  and select the function of your choice in order to customise your telephone.

17.1 Phone settings

17.1.1 Display

Wallpaper

The wallpaper is displayed when you switch on your telephone.

By selecting "**Wallpaper**" you can customise it by replacing the default image or animation displayed on your telephone.

Power On/Off⁽¹⁾

You can customise your welcome animation or image that appears when you switch on your phone.

You can also customise your OFF screen with an image or animation.

Brightness

You may adjust black level with respect to LCD display.

⁽¹⁾ Depending on the model.

17.1.2 Date and time

Allows you to have settings of date and time, including 12/24h format.

You can also set the daylight saving adjustment.

17.1.3 Languages⁽¹⁾

Display language for phone display. The "**Auto**" option selects the language according to the home network (if available).

17.1.4 Headset mode

Switch audio play (incoming call, message beep, alarm beep...) between **Headset only** and **Phone and headset**.

17.1.5 Auto key lock

Your touchscreen will be locked automatically if the phone has been idle for a certain length of time set by you or you may lock it manually with a short press of  key.

Unlock the screen

You may drag down on the locked screen.

17.1.6 Input mode⁽²⁾

Please see chapter "**Latin input method**", page 72. In addition to the specific characters table for Cyrillic, Chinese, other data input modes are also available in your telephone. This feature allows you to write short messages and add names with special characters to your contacts.

⁽¹⁾ Contact your network operator to check service availability.

⁽²⁾ Depending on your network operator.

17.2 Call settings

17.2.1 My number

Type in or modify your telephone number or the number to access your voicemail. Your telephone number is usually written on your SIM card.

17.2.2 Billing ⁽¹⁾

You can access different items with this option:

Amount	Display Last call cost/Total cost/Max cost/Reset cost/Price per unit. You can view the last call cost/total cost/max cost/reset cost/price per unit of charged calls, modify or reset them.
Duration	You can view the total duration of all outgoing calls or reset it.

17.2.3 Call waiting

Activate/deactivate the notification of a second incoming call by a beep.

17.2.4 Call forwarding

You can activate, cancel or verify the status of the call forwarding to the voicemail or to a specified number.

17.2.5 Call barring

You can activate or deactivate the call barring for outgoing and incoming calls. The various options are:

Outgoing calls

The following configurations are possible:

- **All calls** All outgoing calls are barred.
- **International calls** Outgoing international calls are barred.
- **International except home** Outgoing international calls except those to your country of subscription are barred.

Incoming calls

The following configurations are possible:

- **All calls** All incoming calls are barred.
- **Roaming** Incoming calls are barred when you are abroad.

Cancel all

Deactivate all call barring.

Change barring password

Change the original Password for activating call barring.

17.2.6 Caller ID

You can choose Set by network, Hide number or Send number.

⁽¹⁾ Contact your network operator to check service availability.

17.3 Call filter

Your phone is equipped with a call filter function for filtering calls and messages.

To access the function from the main menu, select "**Call filter**".

Blacklist	Enable blacklist, all callers in the list will be automatically blocked.
Whitelist	Enable whitelist, only callers in the list can be connected.
Settings	Enable/disable blacklist, whitelist and call filter.

17.4 Network

Network selection

Preferred network	List of networks to which you wish to be connected in order of priority.
Select network	The choice of network connection is left up to the user.
Search mode	Network connection can be switched between " Manual " and " Auto ".

GPRS international roaming

GPRS data services can be used while roaming overseas.

17.5 Connectivity

A set of profile settings for message (MMS...) and Wap connection.

17.6 Security

SIM

Activate PIN The SIM card protection code is requested each time the phone is powered on if this code is activated.

Change PIN Change PIN code.

Change PIN2 A protection code for certain SIM card features (Billing/Cost/FDN, etc.) will be requested if you attempt to access it, if the code is activated. Select to update it with a new one (between 4 and 8 digits).

Fixed dial number ⁽¹⁾ Allows the phone to be "locked" so that it can only dial certain numbers, or numbers with certain prefixes. To activate this function, PIN2 code is mandatory.

Phone security

Active code Code is requested each time the phone is powered on.

Change code Change phone password, its initial one is 1234.

17.7 Restore default

You can select the browser of your choice as the default browser.

⁽¹⁾ For single SIM model only.

17.8 Dual SIM settings ⁽¹⁾

Dual SIM activated Keep both of your SIM cards active

Only SIM1 activated Only keep SIM1 active



Only SIM2 activated Only keep SIM2 active

18 Call log.....

18.1 Access

You may access this function from the main menu "**Call log**".

For dual SIM model, the complete call logs of both SIM1 and SIM2 are available in this menu.



-  Missed calls/Rejected calls
-  Outgoing calls (Redial)
-  Answered calls

18.2 Available options

You can have access to **Delete**, **Send message**, **Call**, etc.

⁽¹⁾ 3040D only.

19 Calendar.....

To access this function, touch  to enter the main menu and select , there is a monthly-view calendar for you to keep track of important meetings, appointments, etc. Days with events entered will be marked in color.

To do list

You can set time (start and end), alarm or ringtone, etc. in To do list to remind you.

Voice alarm

You can record a reminder using your voice at the date/time you choose!

Available options:

- | | |
|---------------------|---|
| Jump to date | Input the required date and it will be immediately highlighted. |
| All events | Display the list you set in To do list. |
| Go to today | Go back to Today. |

20 Tasks.....

Enables you to easily manage and track the progress of a task with priorities. All the tasks will be sorted by due date.

Available options:

- Create** Create new task
- Edit** Edit the task
- Delete** Delete the task

21 Notes

You can create a note in text format by accessing "**Notes**" from the main menu.

Available options:

- Send** Send by SMS, MMS or Bluetooth.
- Edit** Edit the note
- Delete** Delete the current note or selected notes

22 Calculator.....

Access this feature by selecting "**Calculator**" from the main menu.

Enter a number, select the type of operation to be performed, and enter the second number, then touch "=" to display the result.

Once an operation is complete, you can select "C" to clear numbers and carry out a new operation.

To return the main menu, touch .

To return to the Home screen, press .

23 My files.....



You will have access to all audio and visual files stored in phone or SD card in My files.

23.1 Phone

An access point for all files in all folders stored in phone.

23.2 SD Card

You can access all files stored in the memory card here.



When a microSD card is inserted for the first time, it will be scanned and default folders will be created.

Inserting and removing the microSD card:

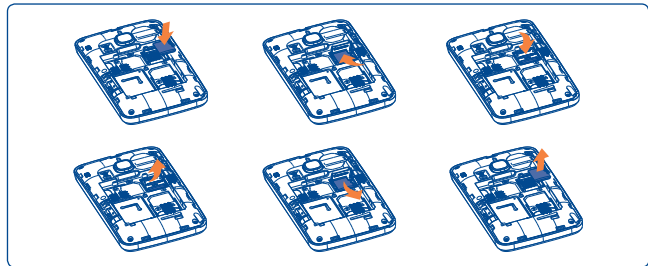

Place the microSD card with the chip facing downwards and slide it into its housing. Make sure that it is correctly inserted. To remove the card, press and slide it out.

Available options

- | | |
|-------------------------|---------------------------------------|
| Create folder | Create more folders. |
| Delete folder | Remove folders. |
| Rearrange folder | Rearrange folders by time, size, etc. |

23.3 Memory status

Indicates how much space is used and how much is currently free on your phone and SD card (if any).

23.3.1 Phone

View available memory space.

Your phone's memory is shared among several functions: contacts, calendar, messages, images, melodies, games and video clips.

23.3.2 Memory card

View the memory available on your microSD card.

You are advised to save large files (like songs) on your microSD card.

24 Converter.....

You can use the Weight and Length conversion by selecting the unit you wish to convert via , then touch to input the digits. Finally confirm with "OK".

25 Stopwatch

The stopwatch is a simple application for measuring time with the possibility to register several results and suspend/resume measurement.

26 Ebook

A bookshelf contains the electronic books (.txt file only). While reading the book, you may add a bookmark, or reach the text by searching words, phrases.

Available options:

Open	Open the current ebook.
Book information	Display the detailed information (title, size and format) about the book.
Delete	Delete the current book.
Delete all	Delete all the books.
Sort	Sort the books by name, type, time or size.
Settings	Set the font, scroll mode, display format, etc.



To avoid character corruption, please ensure that the encoding format is correct.

27 Alarm.....

Your mobile phone has a built-in alarm clock with a snooze feature. You can set up to five separate alarms and choose whether or not the alarm should repeat.

Repeat	You may select Once (default)/ Every day/Weekly/Monthly/Yearly or customize to your desire.
Snooze	The alarm will repeat at regular intervals.
Mode	You may select the mode of Ringtone: Ring only, Vibration only, Radio⁽¹⁾ or Vib. and ring.
Ring tone	You may choose one melody as the alarm ringtone.

⁽¹⁾ In Radio mode, you are required to plug in headset first. Your phone will power on automatically before Radio is on.

28 World clock

The World clock shows current local time and the time zone in different cities. You may view up to 3 cities at one time.

Available options:

Add	When My Cities is full, Add is unable to touch.
View	You can view world time.
More	Choose Delete, Daylight saving on or Daylight saving off with this option.

29 Wap ⁽¹⁾

You may access to Web service by Obigo Browser and launch the Web browser with the homepage of the default profile. Access your favorite website, enter the URL of Website and something else configuration same as most handset browser has.

Homepage	Launch the Wap browser with the preset homepage.
Bookmarks	Access your favourite sites.
Recent pages	Pages which you recently browsed.
Go to URL	Enter the URL of website.
Service inbox	Store WAP push messages.
Settings	Customise your browser preferences.

⁽¹⁾ You can stop loading webpage by touching .

30 Bluetooth™ (1)



Access this feature by touching  to enter the main menu, then selecting "Bluetooth".

To use your phone with a Bluetooth device, you need to proceed in two steps:

- Pair and register the device to your phone,
- Select it to use hands-free communication. Only one Bluetooth audio device (your Bluetooth headset or your Bluetooth car kit) can be connected during the communication.

Pair and register your Bluetooth device

Activate the Bluetooth feature by selecting the "Bluetooth\Activation\On" option. Then enter the "Device list\Search" menu to search for connectable Bluetooth devices. From the list, touch the device you want to pair directly or locate the device then touch  to connect. If the Bluetooth device has very limited I/O capabilities, such as a headset, you may need to enter a fixed PIN to register it with your phone, or you may simply get prompted to confirm the connection. If the device has a display and can accept a binary Yes/No input, such as a mobile phone, you phone and the device will display a numeric code for comparison. Confirm the connection if the codes are identical and the devices will be connected. Or if the device has no display but has numeric keypad entry, such as a keyboard, your phone will display a numeric code. You may need to enter the code on both devices to get them connected, or you may just need to confirm the connection on your phone and enter the code on the other device.

(1) You are recommended to use ALCATEL ONE TOUCH Bluetooth headsets, which have been tested and proved compatible with phone. You can go to www.alcatelonetouch.com for more information about ALCATEL ONE TOUCH Bluetooth headset.

Touch "More" to show service, rename, authorization, delete and delete all from the connected list.



Don't forget to turn on your Bluetooth device and activate the pairing mode while pairing it with your phone.

Visibility

Select whether you want to hide or show to all.

My phone's name

You may change your phone name, which is visible to the others.

Available functions

Data transmit

Exchange files with another bluetooth device.

Handle a call

Initiate or receive a phone call with a Bluetooth headset.

Listen to music

Support A2DP profile.

Dialup networking profile

Network connection can be activated via bluetooth.



Always activate Bluetooth in your phone first before connecting it to a Bluetooth device. Be aware that Bluetooth activation will slightly affect battery life of your phone.

Bluetooth technology allows free wireless connections between all Bluetooth-compliant devices within short range. Please make sure that the Bluetooth headset or the Bluetooth car kit and your mobile phone are in this range and set as visible.

31 Services

Contact your network operator to check service availability.

32 Profiles.....

With this menu, you may personalise ringtones for different events and environments.

32.1 General

You can modify the sound settings within any profile.

Alert type	You can select Ring only, Vibration only, Vib. and ring, Vib. then ring or Silence.
Ring type	Select Ascending, Beep once or Repeat as ring type.
Incoming call	Select a melody from the list or select from file.
Ringtone volume	Adjust ringtone volume.
Message	Select a melody for a new incoming message.
Touch beep	Select Silence, Vibration or Tone for your phone.
Power on	Select a Power on melody for your phone.
Power off	Select a Power off melody for your phone.
Vibration	The phone will only vibrate when this selected.

32.2 Vibrate

All sounds are replaced by vibrations except for alarms.

32.3 Silence

This profile will turn off all ringtones, including notification sounds.

32.4 Flight mode

Voice calls, Bluetooth and Messages functions are barred. It can be used to increase standby duration.

33 Twitter ⁽¹⁾

Twitter is a social networking and microblogging service that has gained notability and popularity worldwide. This feature enables phone users to exchange news updates and ideas with a community in the form of messages or posts. Posts are displayed on the author's profile page and delivered to the author's subscribers or followers.

To open an account online, please go to: <http://m.twitter.com>.

⁽¹⁾ You need to download the application to your phone for the first time. Some data charges may apply during the downloading.

34 Y! Weather ⁽¹⁾

Your phone is equipped with a weather function for consulting up to 3-day forecasts of favourite cities.

To access the function from the Home screen, touch  from tool bar to access the main menu and select .

Search Search cities

Weather forecast Forecast weather in 5 days or in 6-10 days

35 Gameloft ⁽¹⁾

You can download great mobile games for your phone at Gameloft.

⁽¹⁾ You need to download the application to your phone for the first time. Some data charges may apply during the downloading.

36 Making the most of your mobile.....

36.1 PC suite

You can download PC Suite for free from the website. The PC suite includes:

- **Backup/restore**

You can backup the important data in your mobile and restore them when needed.

- **EDGE/GPRS modem**

Use your mobile phone to connect PC to the internet.

- **Multimedia Personalization**

Customize your mobile with images, animations and melodies.

- **Messages**

You can compose SMS/MMS easily on your PC and transfer them to your phone.

Supported Operating Systems

Windows XP/Vista/Windows 7.

ONE TOUCH Upgrade

Using ONE TOUCH Upgrade tool you can update your phone's software from your PC.

Download ONE TOUCH Upgrade from ALCATEL ONE TOUCH website (www.alcatelonetouch.com) and install it on your PC. Launch the tool and update your phone by following the step by step instructions (refer to the User Guide provided together with the tool).

Your phone's software will now have the latest software.



All personal information will be permanently lost following the update process. We recommend you backup your personal data using PC Suite before upgrading.

36.2 Webcam ⁽¹⁾

You can use your phone as a webcam for instant messaging on your PC.

- Connect your phone to PC via USB cable.
- Go to "**My computer**" folder on your PC and find USB video device.

⁽¹⁾ The using of webcam may vary according to the operating system of your PC.

37 Latin input mode/ character table

There are two text entry methods that can be used to write messages

- Normal
- Predictive mode

Normal

This mode allows you to type text by choosing a letter or a sequence of characters.

Predictive mode

This mode can perform predictive input in virtual keypad and supports multi-language input.

Touch inputting

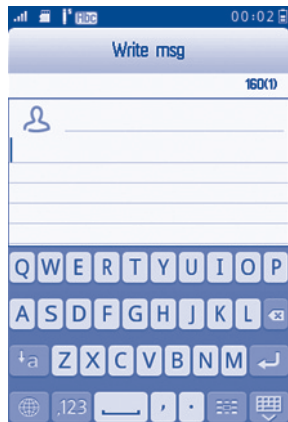

Switch mode of input method



Switch between ABC/abc/Abc



- Tap to delete one by one
- Long touch to delete all



Confirm an option
Switch to a new line (in SMS/ Email/IM)



Close input keypad

38 Telephone warranty.....

Your phone is warranted against any defect or malfunctioning which may occur in conditions of normal use during the warranty period of twelve (12) months ⁽¹⁾ from the date of purchase as shown on your original invoice.

Batteries ⁽²⁾ and accessories sold with your phone are also warranted against any defect which may occur during the first six (6) months ⁽¹⁾ from the date of purchase as shown on your original invoice.

In case of any defect of your phone which prevents you from normal use thereof, you must immediately inform your vendor and present your phone with your proof of purchase.

If the defect is confirmed, your phone or part thereof will be either replaced or repaired, as appropriate. Repaired Phone and accessories are entitled to a one (1) month warranty for the same defect. Repair or replacement may be carried out using reconditioned components offering equivalent functionality.

This warranty covers the cost of parts and labor but excludes any other costs.

⁽¹⁾ The warranty period may vary depending on your country.

⁽²⁾ The life of a rechargeable mobile phone battery in terms of conversation time standby time, and total service life, will depend on the conditions of use and network configuration. Batteries being considered expendable supplies, the specifications state that you should obtain optimal performance for your phone during the first six months after purchase and for approximately 200 more recharges.

This warranty shall not apply to defects to your phone and/or accessory due to (without any limitation):

- 1) Non-compliance with the instructions for use or installation, or with technical and safety standards applicable in the geographical area where your phone is used,
- 2) Connection to any equipment not supplied or not recommended by TCT Mobile Limited,
- 3) Modification or repair performed by individuals not authorised by TCT Mobile Limited or its affiliates or your vendor,
- 4) Inclement weather, lightning, fire, humidity, infiltration of liquids or foods, chemical products, download of files, crash, high voltage, corrosion, oxidation...

Your phone will not be repaired in case labels or serial numbers (IMEI) have been removed or altered.

There are no express warranties, whether written, oral or implied, other than this printed limited warranty or the mandatory warranty provided by your country or jurisdiction.

In no event shall TCT Mobile Limited or any of its affiliates be liable for indirect, incidental or consequential damages of any nature whatsoever, including but not limited commercial or financial loss or damage, loss of data or loss of image to the full extent those damages can be disclaimed by law.

Some countries/states do not allow the exclusion or limitation of indirect, incidental or consequential damages, or limitation of the duration of implied warranties, so the preceding limitations or exclusions may not apply to you.

39 Accessories.....

The latest generation of ALCATEL ONE TOUCH GSM mobile phones offers a built-in handsfree feature that allows you to use the telephone from a distance, placed on a table for example. For those who prefer to keep their conversations confidential, an earpiece is also available known as the headset.

1. Charger
2. Battery
3. USB cable
4. Stereo headset



Only use your telephone with ALCATEL ONE TOUCH batteries, chargers and accessories in your box.

40 Troubleshooting

Before contacting the service centre, you are advised to follow the instructions below:

- You are advised to fully charge () the battery for optimal operation.
- Avoid storing large amounts of data in your phone as this may affect its performance.
- Use User Data Format and the ONE TOUCH Upgrade tool to perform phone formatting or software upgrading, (to perform User Data format, touch **Settings/Restore default**). ALL User phone data: contacts, photos, messages and files, downloaded applications will be lost permanently. It is strongly advised to fully backup the phone data and profile via PC suite before doing formatting and upgrading.

and carry out the following checks:

My phone cannot switch on

- Check the battery contacts, remove and reinstall your battery, then turn your phone on
- Check the battery power level, charge for at least 20 minutes
- If it still does not work, please use ONE TOUCH Upgrade to upgrade software

My phone is frozen or has not responded for several minutes

- Restart your phone by pressing and holding the  key
- Remove the battery and re-insert it, then restart the phone
- If it still does not work, please use ONE TOUCH Upgrade to upgrade software

My phone turns off by itself

- Make sure power off key is not mis-contacted
- Check the battery charge level
- If it still does not work, please use ONE TOUCH Upgrade to upgrade software

My phone cannot charge properly

- Make sure you are using an ALCATEL ONE TOUCH battery and the charger from the box
- Clean the battery contact if it's dirty
- Make sure your battery is inserted properly before plugging in the charger
- Make sure that your battery is not completely discharged; if the battery power is empty for a long time, it may take around 20 minutes to display the battery charger indicator on the screen
- Make sure charging is carried out under normal conditions (0°C to +40°C)
- When abroad, check that the voltage input is compatible

My phone cannot connect to a network or “No service” is displayed

- Try connecting in another location
- Verify the network coverage with your operator
- Check with your operator that your SIM card is valid
- Try selecting the available network(s) manually (see page 53)
- Try connecting at a later time if the network is overloaded

My phone cannot connect to the Internet

- Check that the IMEI number (press *#06#) is the same as the one printed on your warranty card or box
- Make sure that the internet access service of your SIM card is available
- Check your phone's Internet connecting settings
- Make sure you are in a place with network coverage
- Try connecting at a later time or another location

Invalid SIM card

- Make sure the SIM card has been correctly inserted (see page 16)
- Make sure the chip on your SIM card is not damaged or scratched
- Make sure the service of your SIM card is available

Touch screen does not respond accurately

- Make sure your phone is not locked
- Put the battery out and restart the phone
- If it still does not work, please use ONE TOUCH Upgrade to upgrade software

Unable to make outgoing calls

- Make sure you have dialed a valid number and press the  key
- For international calls, check the country and area codes
- Make sure your phone is connected to a network, and the network is not overloaded or unavailable
- Check your subscription status with your operator (credit, SIM card valid, etc.)
- Make sure you have not barred outgoing calls (see page 52)
- Make sure that your phone is not in flight mode

Unable to receive incoming calls

- Make sure your phone is switched on and connected to a network (check for overloaded or unavailable network)
- Check your subscription status with your operator (credit, SIM card valid, etc.)
- Make sure you have not forwarded incoming calls (see page 51)
- Make sure that you have not barred certain calls
- Make sure that your phone is not in flight mode

The caller's name/number does not appear when a call is received

- Check that you have subscribed to this service with your operator
- Your caller has concealed his/her name or number

I cannot find my contacts

- Make sure your SIM card is not broken
- Make sure your SIM card is inserted properly
- Import all contacts stored in SIM card to phone

The sound quality of the calls is poor

- You can adjust the volume during a call
- Check the network strength 
- Make sure that the receiver, connector or speaker on your phone is clean

I am unable to use the features described in the manual

- Check with your operator to make sure that your subscription includes this service
- Make sure this feature does not require an ALCATEL ONE TOUCH accessory

When I select a number from my contacts, the number cannot be dialed

- Make sure that you have correctly recorded the number in your file
- Make sure that you have inputted the country prefix when calling a foreign country

I am unable to add a contact in my contacts

- Make sure that your SIM card contacts are not full; delete some files or save the files in the phone contacts

My callers are unable to leave messages on my voicemail

- Contact your network operator to check service availability

I cannot access my voicemail

- Make sure your operator's voicemail number is correctly entered in "Messaging\Alerts\Voicemail server"
- Try later if the network is busy

I am unable to send and receive MMS

- Check your phone memory availability as it might be full
- Contact your network operator to check service availability and check MMS parameters (see page 35)
- Verify the server centre number or your MMS profile with your operator
- The server centre may be swamped, try again later

The flickering icon is displayed on my standby screen

- You have saved too many short messages on your SIM card; delete some of them or archive them in the phone memory

SIM card PIN locked

- Contact your network operator to obtain the PUK code (Personal Unblocking Key)

I am unable to connect my phone to my computer

- Install ALCATEL ONE TOUCH PC suite first of all
- Check that your computer meets the requirements for ALCATEL ONE TOUCH PC Suite installation
- Make sure that you're using the right cable from the box

I am unable to download new files

- Make sure there is sufficient phone memory for your download
- Select the microSD card as the location to store downloaded files
- Check your subscription status with your operator

The phone cannot be detected by others via Bluetooth

- Make sure that Bluetooth is turned on and your phone is visible to other users (see page 65)
- Make sure that the two phones are within Bluetooth's detection range

How to make your battery last longer

- Make sure you follow the complete charge time (minimum 3 hours)
- After a partial charge, the battery level indicator may not be exact. Wait for at least 20 minutes after removing the charger to obtain an exact indication
- Exit background-running applications if they are not being used for a long time
- Deactivate Bluetooth, Wi-Fi when not in use

ALCATEL is a trademark of Alcatel-Lucent
and is used under license by
TCT Mobile Limited.

All rights reserved © Copyright 2013
TCT Mobile Limited.

TCT Mobile Limited reserves
the right to alter material or technical
specification without prior notice.